

Thermalrock™ S (Slab)



General Product Information

ROCKWOOL stone wool products are made of basalt, a volcanic stone, which is the world's most abundant natural resource.

ROCKWOOL stone wool products are non-combustible with a melting point more than 1000°C. They are particularly suitable for thermal insulation, fire protection and sound reduction or absorption.

ROCKWOOL stone wool is inorganic and contains no nutritious substance. Therefore it will not be attacked by microorganisms. Stone wool will not rot and does not attract vermin.

No CFCs, HFCs, HCFCs, or asbestos are used in the manufacture of ROCKWOOL stone wool products.

Applications

Thermalrock S is manufactured in a wide variety of thicknesses and densities to suit most requirements, suitable for general application in residential, commercial and industrial buildings.

Reaction to Fire Classification

ROCKWOOL Thermalrock S range achieves an A1 Non-Combustible reaction to fire classification; including faced and unfaced variations.



Technical Parameters

Product Types	S40	S50	S60	S80	S90	S100	Standards
Nominal Density (kg/m ³)	40	50	60	80	90	100	
Thermal Conductivity at 20°Cλ (W/mK)*	0.034	0.034	0.035	0.035	0.036	0.036	ASTM C518
Sound Absorption Class	Please contact your local representative for more information.						ISO 354 / ASTM C423
Fire Performance	Non-combustible / A1 Fire Classification						EN 13501-1 / UL 723
Water Vapor Absorption*	0.004 % by Vol						ASTM C1104 / C1104M
Water Absorption (Partial Immersion)*	< 0.23 kg/m ²						EN 1609.97

Note: *Best typical values achieved during one of the test batch conducted.

Acoustic Performance

Due to the naturally random orientation of ROCKWOOL fibers, all ROCKWOOL products make excellent acoustic absorbers; the ROCKWOOL Thermalrock S range has been extensively tested and has a proven track record to substantially improve the acoustic performance of any application.

On the next page is a sample graph of the acoustic absorption coefficients that can be achieved; it must also be noted that the majority of thicknesses and densities have achieved a Class A absorber rating.

For further acoustic information please contact our technical representatives.

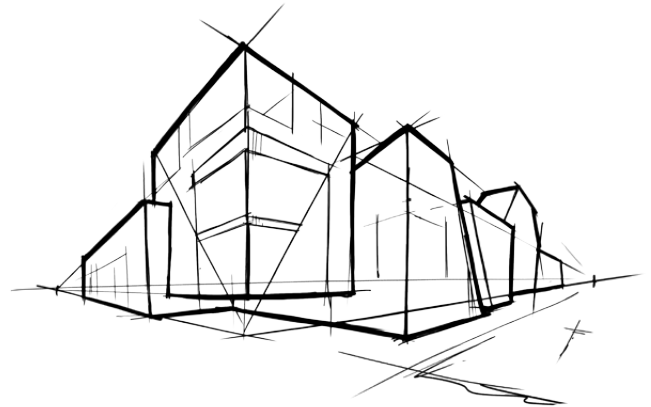
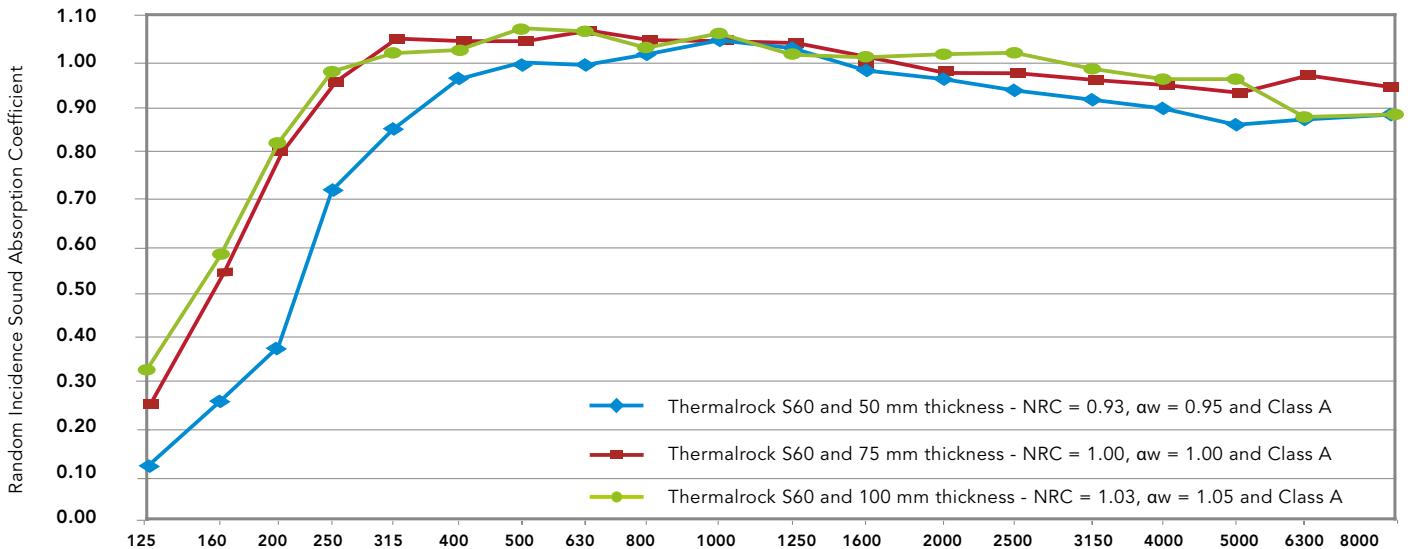

Figure 2: Plot for Random incidence sound absorption coefficient (RISAC) of Thermalrock S60 50 mm, 75 mm and 100 mm at one third octave frequencies



Partition applications

ROCKWOOL Thermalrock S is a high quality insulation slab, suitable for metal and timber frame partition walls. It is easy to fit and provides excellent acoustic and thermal performance as well as fire protection. It has undergone rigorous testing and has attained a Class A absorption rating for acoustic and Noncombustible / A1 Fire Classification under EN13501-1.

Thermalrock S is suitable for both residential and commercial applications.

Thermalrock S100 – Commonly used in fire-rated partition system that would like to achieve the required fire rating without compromising the acoustic requirements.

Thermalrock S60 – Used in general partition system that would allow users to achieve high level of acoustic performance, yet it is easy to handle and installed in the partition walls.

With years of research and experience, ROCKWOOL have developed the know-how in providing the best value for money acoustic and fire insulation solution for all your partition walls need.



Façade application

Thermalrock S80 is designed for installation behind façade constructions. This material gives a high level of acoustic and thermal protection to the envelope of the building; whilst maintaining its non combustible certification. When installed correctly the slabs will knit together, thereby reducing any extraneous heat loss through the board joints. Due to the materials open cell nature, this product allows the structure to breath reducing the risk of condensation.

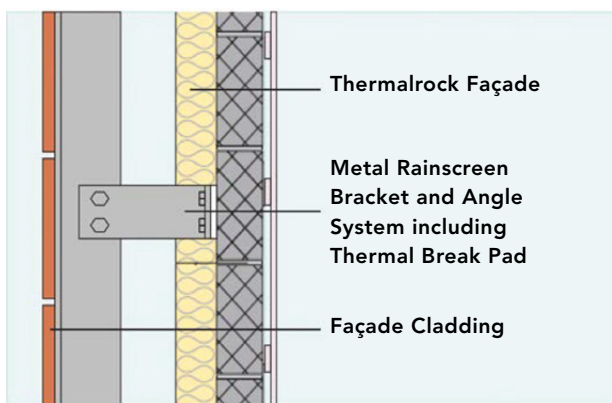

To obtain the optimum performance from the system the slabs should be applied vertically with all joints tightly butted together.

Dimension

Length (mm)	Width (mm)	Thickness (mm)	Density (kg/m ³)
1000	600	40, 50, 75, 100, 200	40
1000	600	30, 50, 75, 100, 200	50
1000	600	25, 30, 50, 75, 100, 200	60
1000	600	25, 30, 50, 75, 100, 200	80
1000	600	25, 30, 50, 75, 100, 165	90
1000	600	25, 30, 50, 75, 100, 160	100

Note: Please contact your local representatives for sizes and densities not stated in the data sheet

Packing and Storage

Thermalrock S is shrink-wrapped in polyethylene sheets for ease of handling, transportation, storage and identification. Products should be stored indoors or under a waterproof covering.



Toll Free Number 18002669861

Disclaimer: The information contained in this data sheet is believed to be correct at the date of publication. ROCKWOOL does not accept responsibility for the consequences of using Thermalrock S in applications different from those described above.

ROXUL-ROCKWOOL

Insulation India Pvt. Ltd.

Plot-Z/4, Dahej SEZ
Dahej District Bharuch-392 130
Gujarat-India
T (+91) 2641 619400
F (+91) 2641 256292

ROXUL-ROCKWOOL Technical

Insulation India Pvt. Ltd.

Wing B-2, 2nd Floor, Unit No.206 Boomerang, Near
Chandivali Film Studio Chandivali Farm Road,
Andheri (E) Mumbai - 400 072, Maharashtra, India
T (+91) 2267157700
F (+91) 2267 15 7710

www.rockwoolasia.com